



PRODUCT DATASHEET

ZONA® WPC Decking connector

30.11.2020 This copy is not subject to the print or paper form



FIXINGGROUP GmbH

www.fixinggroup.com

office@fixinggroup.com

| | |
|--|--|
| 1. Unique identification code of the product type | ZONA WPC Decking connector |
| 2. Label for identification of the product | Type description: See product packaging |
| 3. Intended purpose of use | Decking connector for side grooved boards |
| 4. Manufacturer | FIXINGGROUP GmbH |
| 5. Test method for evaluating and monitoring performance | Compression tests Determination of limit values and deformation behaviour |
| 6. Harmonized standard - CE declaration of conformity mark | Not subject to declaration of conformity |
| 7. Declared performance | According to the tables below |

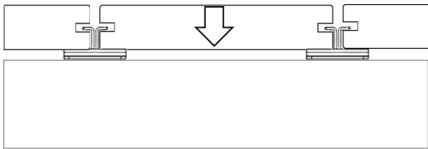
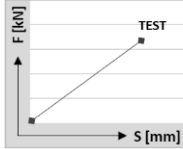
| | |
|---|--|
| General information | |
| 1.1. Fastening type | Side groove hidden mounting system Two integrated locking grips on the groove engagement plate on both sides, possible swelling or shrinking of the decking boards cannot be controlled by the fastener. This type of function is only suitable for decking boards with very high dimensional stability |
| 1.2 Material | - ZONA stainless steel 1.4301 / optionally with black surface coating Mechanical and chemical wear of the black surface coating cannot be excluded - System screw UNIA Ø 4,2 mm - Revert to datasheet UNIA |
| 1.3 Dimensions | According to the illustration below |
| 1.4 Compression tests The limit values are determined in the load direction under compression. The mechanical properties of the load-bearing capacity and the deformation behaviour were determined via a node. feed speed 4.00 mm/min |   |

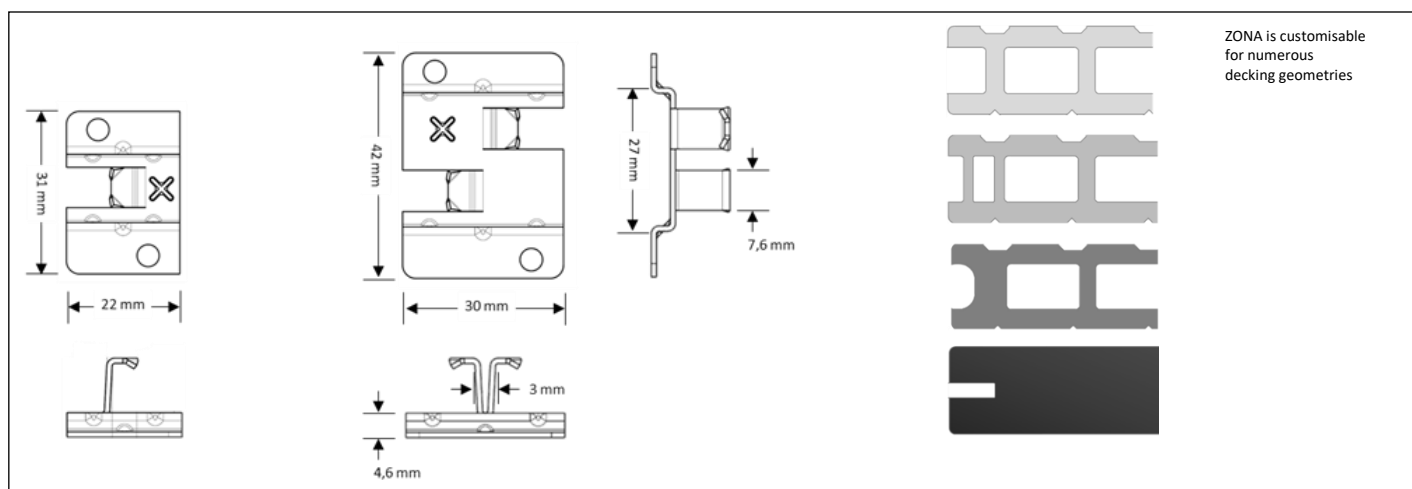

FOR INTERNAL USE ONLY

All information is based on our current knowledge and experience - no guarantee can be derived from our information.

The suitability of the product for a specific application can only be guaranteed by our own tests and trials. The installation is according to the manufacturer's specifications, tips and tricks, installation instructions, technical rules, guidelines and country-specific regulations. The compatibility of the decking connectors with the decking boards must be checked with the board manufacturer/supplier. The correct processing and installation of our products is beyond our control and therefore not our responsibility. We reserve the right to make errors, changes to the product range and technical modifications.



PRODUCT DATASHEET

ZONA® WPC Decking connector

30.11.2020 This copy is not subject to the print or paper form



FIXINGGROUP GmbH

www.fixinggroup.com

office@fixinggroup.com

Installation Instructions:

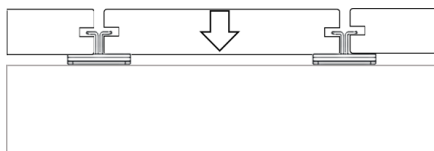
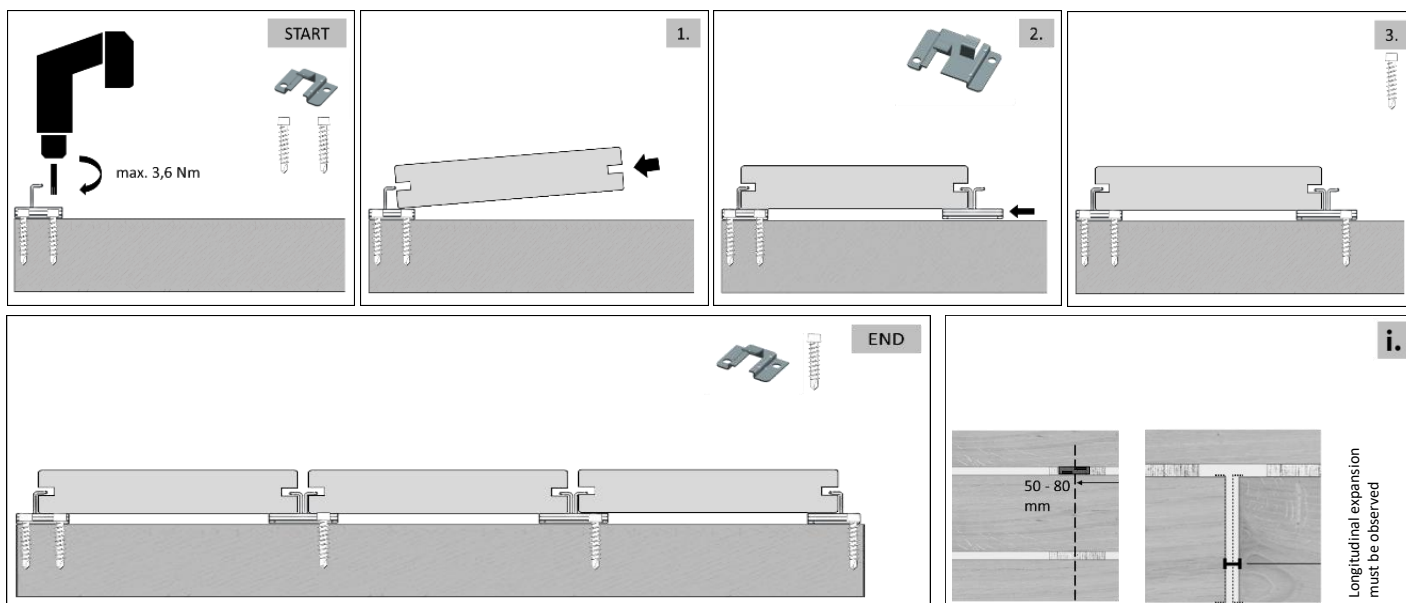

| ZONA Compression tests | | WPC full profile 22 x 143 mm | | | | | |
|---|------------|------------------------------|-----|------|-----|------------------|-----|
| F Force [kN] S Def. [mm] | | F | S | F | S | F _{max} | S |
| Substructure RELO U | TEST 1 | 4,17 | 2,0 | 7,52 | 4,0 | 15,04 | 6,3 |
| | TEST 2 | 3,19 | 2,0 | 6,41 | 4,0 | 15,04 | 7,4 |
| | TEST 3 | 2,79 | 2,0 | 5,95 | 4,0 | 15,04 | 7,6 |
| | Mean value | 3,38 | 2,0 | 6,63 | 4,0 | 15,04 | 7,1 |
| | Minimum | 2,79 | 2,0 | 5,95 | 4,0 | 15,04 | 6,3 |
| | Maximum | 4,17 | 2,0 | 7,52 | 4,0 | 15,04 | 7,6 |
| max. load_Deformation of the substructure | | | | | | | |